

STOVAX



Stockton Milner Brick Free Standing Stove - Smoke Control Version

MODELS: STMB

Instructions for fitting Smoke Control kit For use in GB (Great Britain)

CE



This appliance has been certified for use in countries other than those stated. To install this appliance in these countries, it is essential to obtain the translated instructions and in some cases the appliance will require modification. Contact Stovax for further information.

IMPORTANT

This appliance will become hot whilst in operation, it is therefore recommended that a suitable guard should be used for the protection of young children, the elderly or infirm. Do not attempt to burn rubbish in this appliance.

Please read these Instructions carefully before installation or use.

Keep them in a safe place for future reference and when servicing the fire.

The commissioning sheet found on page 3 of the main instructions should be completed by the appliance Installer.

THESE INSTRUCTIONS MUST BE USED IN CONJUNCTION WITH PM416

USER INSTRUCTIONS

1. GENERAL

- 1.1 These instructions apply to Stockton Milner Brick when fitted with a Smoke Control kit.

NOTE: These appliances have been independently tested to PD6434 and approved by DEFRA as an exempted appliance allowing it to burn wood in Smoke Control areas when fitted with this Smoke Control kit.

Product Code	Appliance	Smoke control kit Part No.
STMB	Stockton Milner Brick	STMBSCKIT

- 1.2 To meet the Smoke Control requirement this appliance must be operated correctly in order to minimise the amount of smoke produced.
- 1.3 Burn only dry wood or approved smokeless solid fuels.
- 1.4 These instructions must be left with the user and kept with the original instructions they superseded.

2. RECOMMENDED FUELS

2.1 Wood Logs:

- Burn only seasoned timber with a moisture content of less than 20%

Appliance	Maximum Length	Maximum Diameter
Stockton Milner Brick	250mm	100mm

- Allow cut wood to dry for 12 to 18 months before use

Poor quality timber:

- Causes low combustion efficiency
- Produces harmful condensation
- Reduces effectiveness of the airwash and life of the appliance

Do not burn construction timber, painted, impregnated / treated wood, manufactured board products or pallet wood.

3. LIGHTING THE APPLIANCE

- 3.1 For best results:

- Set air controls, Diagram 1

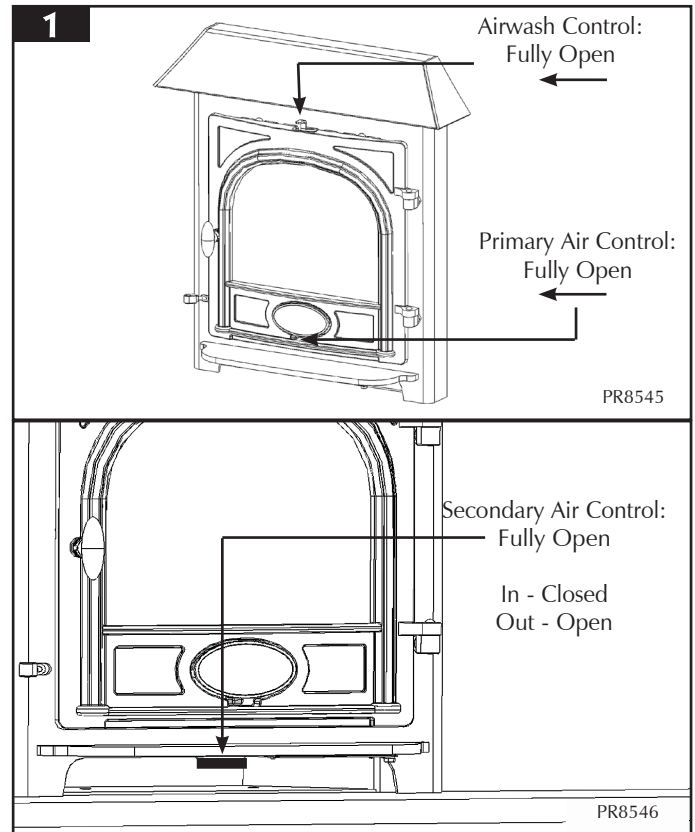

- Place firelighters or paper and dry kindling wood on the grate
- Light the paper or firelighters, Diagram 2



- Leave the door slightly open as the fire establishes and the glass warms to avoid the build-up of condensation
- Add larger pieces of wood
Too many logs may smother the fire.

USER INSTRUCTIONS

Do not load fuel above the log guard and the secondary combustion inlets at the back of the firebox.

Diagram 3

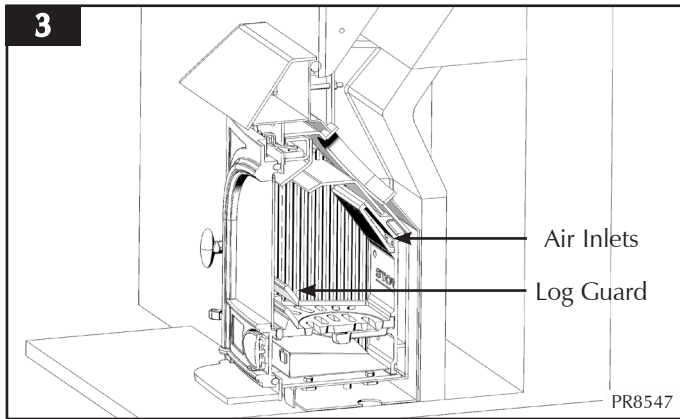

- Close the door fully

4. RUNNING THE APPLIANCE

4.1 Burning Wood:

- Close the **Primary air control** and use the **Airwash** to control the burn rate when appliance is at operating temperature, Diagram 4

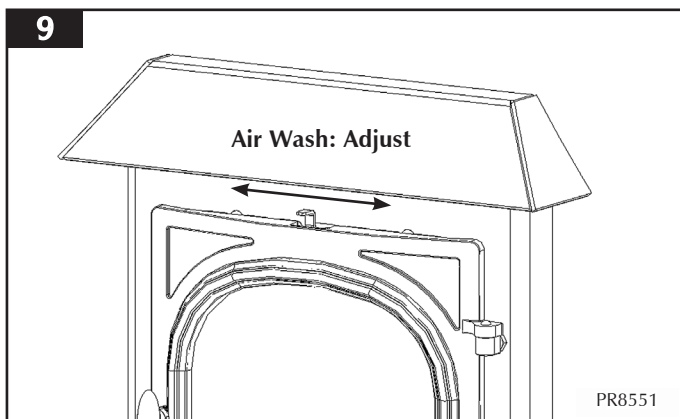

5. REFUELLING THE APPLIANCE

- 5.1 • Open the Primary and Airwash air controls fully
- Rake the embers evenly over the fire bed to establish a glowing firebed
If the fire bed is low add a small amount of kindling wood to help re-establish the fire.
- Stack the logs in an open arrangement, Diagram 5

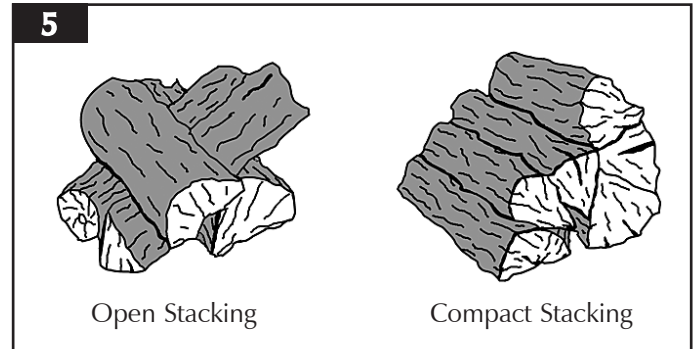

Open stacking allows oxygen to easily reach every part of the fire.
Compact stacking will make the wood burn slower as wood can only reach the outside of the fire. This will cause the fire to smoulder and produce smoke.

- 5.2 After refuelling:
 - **Burn the new logs at high output for 3 to 5 minutes before closing the Primary air control**
Adjusting the burn rate using the Airwash air control.

Do not close the air controls until the fire is burning well.

- 5.3 Experience establishes settings to suit personal preferences.
- 5.4 **Do not** burn large amounts of fuel with the **Airwash control** closed for long periods of time. This reduces the glass cleaning effect and causes tars and creosotes to build-up in the appliance and flue system and will produce excessive amounts of smoke.
- 5.5 When in use, burning the appliance at high output for a short period also reduces tars and creosote.
- 5.6 When running the appliance:
 - **Refuel little and often for clean, efficient burning**
- 5.7 Wood burns best on a bed of ash.

A bright and clean firebox indicates the appliance is burning well.

- 5.8 **Do not load fuel above the log guard and the secondary combustion inlets at the back of the firebox.**
Diagram 3

INSTALLATION INSTRUCTIONS

These instructions cover the fitting of the Smoke Control Kit

1. PARTS LIST

Product Code	Appliance	Smoke control kit Part No.
STMB	Stockton Milner Brick	STMBCKIT

ST3SCKIT:

- 1 x Air Control Slider
- 1 x Air Control Stop

2. INSTALLATION

2.1 To install the Smoke Control kit:

- Remove internal packaging, Log Guard and baffle, Diagram 6

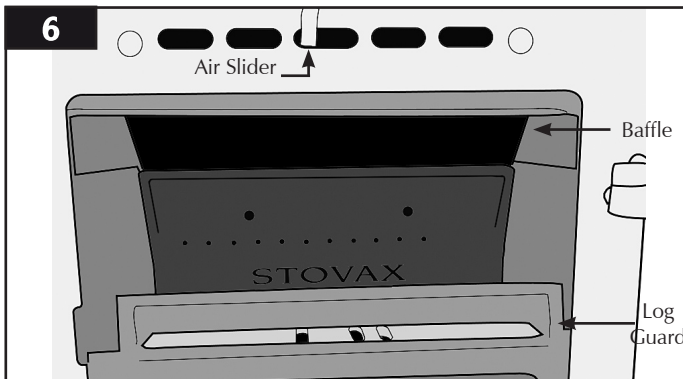

Stage One

2.2 The interior of the appliance is made of several components that effect the fitting of the Smoke Control kit, Diagram 10

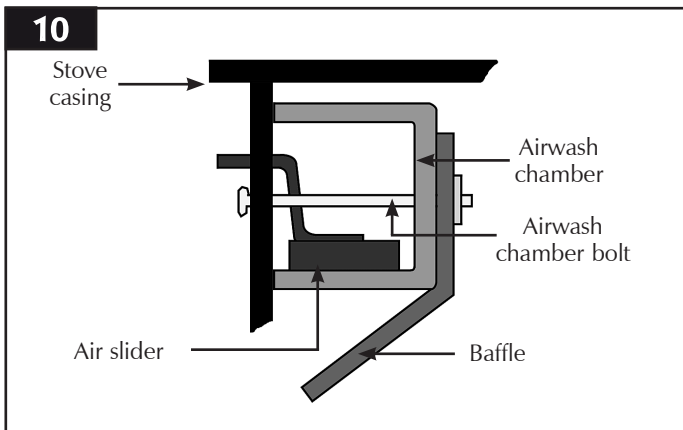

2.3 • Remove the two bolts on the Airwash chamber
These are located on the inside of the stove, Diagram 11

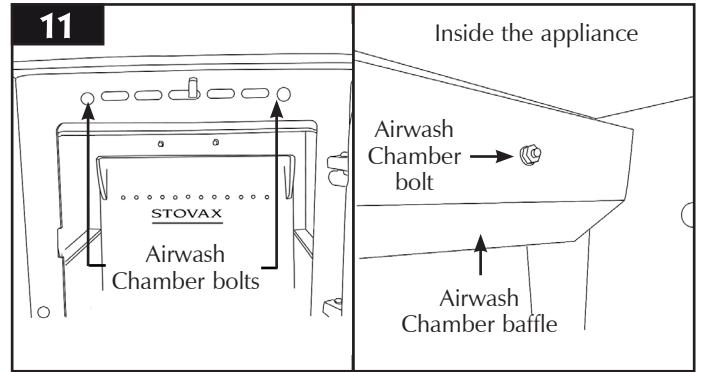

2.4 • Rotate and pull the Airwash chamber through the front of the appliance to remove, Diagram 12

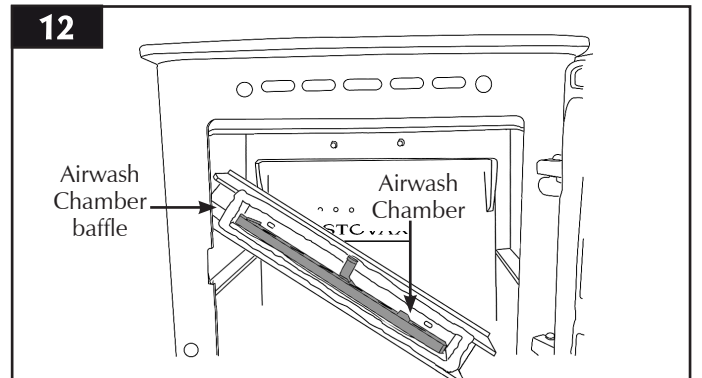

2.5 Replace the Airslider with the Smoke Control version, Diagram 13

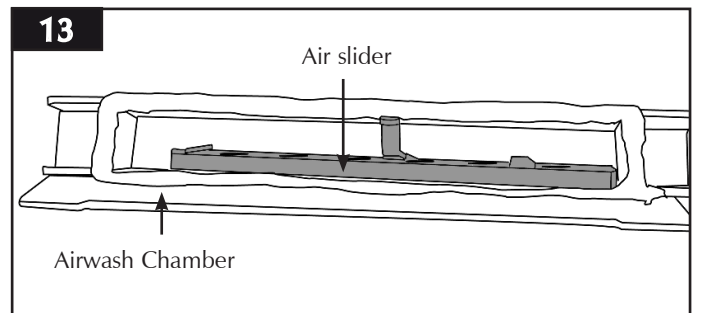

2.6 Fitting is the reverse of the above

2.7 Ensure the Air slider screws are tightened to a tension that ensures movement when the Airwash is operated. The Air slider must be positioned correctly and not rest on the inlet, Diagram 14

INSTALLATION INSTRUCTIONS

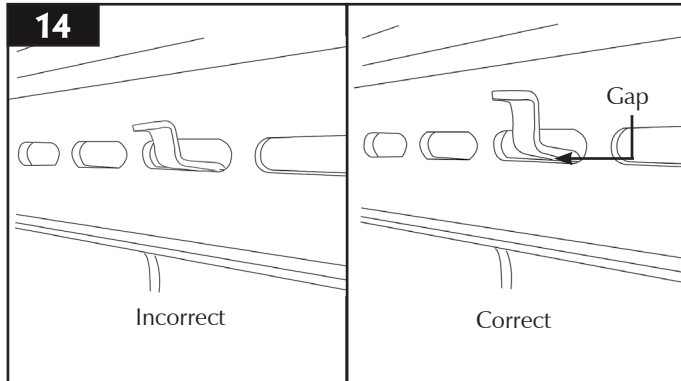

- Stage one is complete

Stage 2 - Door

- 2.8 Using a 10mm A/F spanner remove the left-hand fixing screw on the rear of the door, Diagram 15.

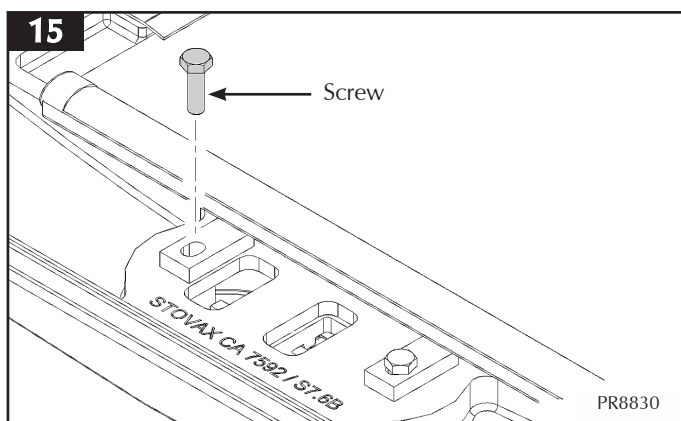

- 2.9 Open the air control fully.

Place the air slider stop in position, with the tag pointing into the air hole, Diagram 16.

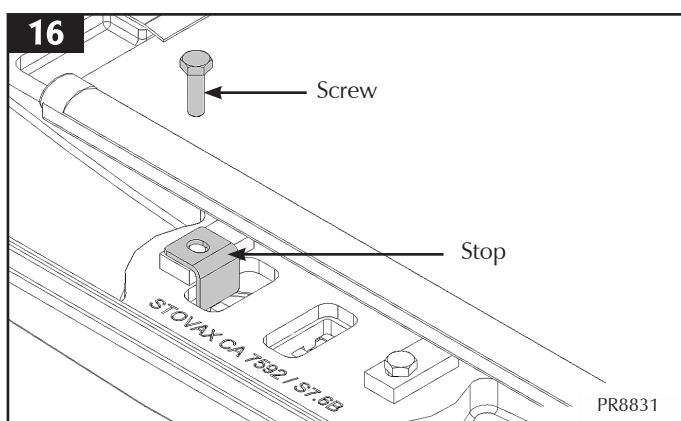

This will stop the control fully closing and a gap of approximately 2mm should be visible, Diagram 17.

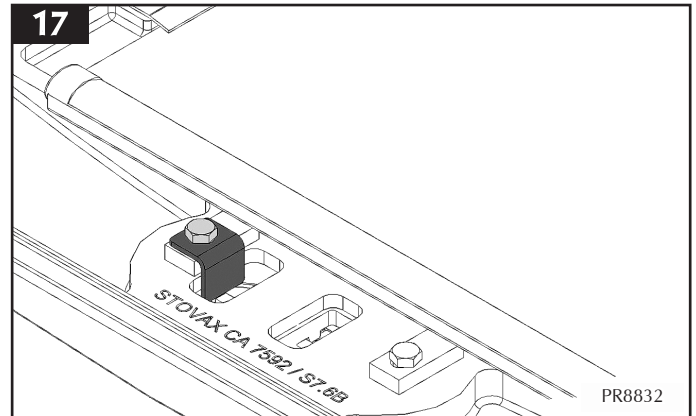

- 2.10 Refit the fixing screw.

Check the control moves freely. Stage two is now complete.

STOVAX

Stovax Ltd, Falcon Road, Sowton Industrial Estate, Exeter, Devon, England EX2 7LF
Tel: (01392) 474011 Fax: (01392) 219932 E-mail: info@stovax.com www.stovax.com